

Kidde ECS Fire Suppression System Marine Series Component Description



Effective: June 2014

K-90-9210M Rev BA

Cradle, 40 and 70 lb. Agent Cylinder

FEATURES

- See Kidde® Manual 90-FM200M-021 for USCG Approval
- For Use in Marine Applications Only
- RoHS Compliant

P/N: WK-878760-000

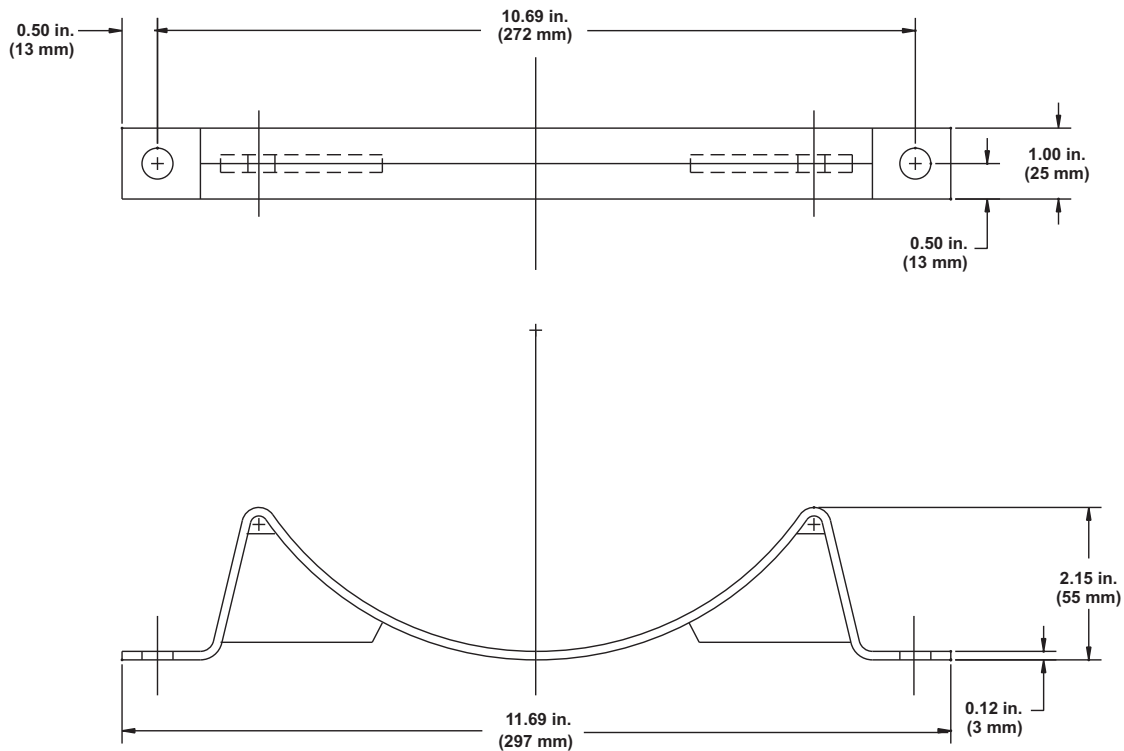

WEIGHT: 1 lb. (0.45 kg)
MATERIAL: Steel
FINISH: Painted Black

COMPATIBILITY

Series	For Use With
Kidde ECS HFC-227ea	X
Kidde ECS Advanced Delivery FM-200®	X

This literature is provided for informational purposes only. KIDDE-FENWAL, INC. assumes no responsibility for the product's suitability for a particular application. The product must be properly applied to work correctly. If you need more information on this product, or if you have a particular problem or question, contact KIDDE-FENWAL, Inc.

FM-200 is a registered trademark of E.I. du Pont de Nemours and Company. Kidde is a registered trademark of Kidde-Fenwal Inc. All other trademarks are the property of their respective owners.